



# SUNDAY SCHOOL

**BIBLE STUDY FOR ALL AGES  
SUNDAYS AT 9:45 AM**

*Your Word is a lamp to my feet  
and a light for my path.*

— Psalm 119:105



**Hayes Barton  
Baptist Church**

**Faith, Hope, Love. And You.**

## **SUNDAY SCHOOL AT HBBC**

We offer a range of Sunday School programs to suit a variety of spiritual needs and desires, from age-specific groups to classes organized by gender, area of study, and much more. The combination of biblical learning and the small-group dynamic makes our Bible Studies the perfect vehicle for spiritual growth and fulfillment. We offer in-person and hybrid options. View our brochure for more details. If you have more questions about our Sunday School classes, please email Kristen Muse ([kmuse@hbhc.org](mailto:kmuse@hbhc.org)).

# TABLE OF CONTENTS

Cashwell .....	4
Danielson .....	4
Fellowship .....	5
Foundations .....	5
Genesis .....	6
Hailey .....	6
Journey .....	7
Koinonia .....	7
Membership Matters .....	8
Reflections .....	8
The Well .....	9
Young Professionals .....	9
Preschool and Grade School .....	10
Middle and High School .....	11
Children and Safety.....	11
Sunday School Class Listing .....	12-13
Building Map .....	14-15
Parking Map .....	16-17
Street Map .....	18-19



## CASHWELL

The Cashwell Sunday School class is a welcoming class that is composed of adults who study, fellowship, and serve together. For years, they have provided meals on Christmas and Thanksgiving Day, as well as a monthly meal at the Helen Wright Women's Center. The class is made up of adults whose children are now moving out into the world to work. Several in the class are grandparents. They use a variety of resources to engage their faith and grow in their understanding of Scripture and God. Teachers rotate each week.

**Co-ed, 60+, Parents of Young Adults | Main Building, second floor (Room 207) at 9:45 AM | Hybrid**

A team teaches with lecture and discussion using Smyth & Helwys Quarterly: Formations.

## DANIELSON

This class provokes thinking outside of the box, engages in rigorous study and discussion of the radical life and teachings of Christ, and probes what that means for changes in our lives today. They do so with the basic Baptist principles such as the Priesthood of the Believer, the separation of church and state, and the autonomy



of the local church, all of which are dependent on individual exploration and thought. The class is quite large, diverse in age, beliefs, and opinions, and is committed to allowing members to express themselves freely in a respectful environment. The curriculum is derived from the Bible using multiple resources and books. Teachers rotate weekly.

**Co-ed, 65+, Married and Single | Main Building, ground floor (Room 30) at 9:45 AM | Hybrid**

A team instructs with facilitated discussion using a variety of resources.



## FELLOWSHIP

The Fellowship Class, whose members range from their seventies to those who have retired, personifies its name. No longer burdened with job schedules and other duties, the class members enjoy the company of one another and the opportunity to visit and study together. The class is taught by four teachers in a rotation. They bring to the class a variety of teaching experience and styles which make for interesting lessons and insights. Class starts at 9:45 AM, but members begin gathering 15 to 20 minutes earlier for visiting and fellowship.

**Co-ed, 70+, Married and Single | Main Building, main floor (Room 111) at 9:45 AM**

A team teaches with lecture and discussion using Smyth & Helwys Quarterly: Connections.



## FOUNDATIONS

The Foundations Class is made up of singles and couples, mostly in their twenties, thirties, and forties. Most of the class members have small children, and they add to that number frequently! The teachers rotate on a weekly basis and the class studies a combination of deep Bible study and application material. Foundations is a warm and loving group that enjoys fellowship on Sunday mornings and through other opportunities outside of the church.

**30+, Young Adults/Career | Chapel Wing, second floor (Room C-205) at 10:00 AM**

Co-teachers instruct with facilitated discussion using a variety of resources.





## GENESIS

The Genesis class is a unique blend of individuals and couples. Many members have middle school children, as well as those that have graduated from college. Using a variety of resources, the class enjoys discussing the Bible, as well as applying topics and Scripture to life experiences. They are also involved in fellowship and service opportunities.

**Co-ed, 40+, Married and Single | Chapel Wing, second floor (Room C-204) at 10:00 AM**

A team instructs with facilitated discussion using Lifeway Quarterly: Bible Studies for Life.



## HAILEY

A class for couples (most, but not all, have young families). They care deeply about each other, the church, and furthering their relationships with Jesus as they grow as Christians together. Using Scripture-based studies that involve group discussions, a team of teachers rotate each week.

**35+, Couples with Preschoolers, Children, and Youth | Main Building, second floor (Room 204) at 10:00 AM**

A team instructs with facilitated discussion using a variety of resources.

## JOURNEY

The Journey Class is a discussion-based class consisting of members, single and couples, in their late 20s and 30s. They enjoy studying the Bible in a way that challenges their faith, embracing uncertainty and thinking about things a little differently. The Sunday morning class encourages healthy debate, centered in fellowship and love of Christ.



**Young Adults/Career, 20+  
Main Building,  
ground floor (Room 24/26)  
at 10:00 AM | Hybrid**  
Co-teachers facilitate a discussion-based class using a various resources.



## KOINONIA

This class reflects its name; they offer fellowship, relationships, and the study of Biblical lessons. Class discussions allow the sharing of experiences and learning from one another. They share. They serve. They laugh. They love. They are long-standing members and newer members. Most have children and grandchildren, but all are children at heart as they enjoy their community of faith together. The class begins with tasty goodies around 9:45 AM every Sunday.

**Co-ed, 65+, Married and Single | Main Building, second floor (Room 200) at 9:45 AM | Hybrid**  
Co-teachers instruct with facilitated discussion using Lifeway Quarterly: Bible Studies for Life.



## MEMBERSHIP MATTERS

If you have recently joined HBBC or are prayerfully considering becoming a member, want more information about deepening your relationship with Christ, have questions about what being a Baptist is all about, or desire more information about how to join the church and how to find a place of service, then we invite you to attend Membership Matters. Learn more and register for the next session at [hbhc.org/membership-matters](https://hbhc.org/membership-matters). Membership Matters meets quarterly.

**Newcomers | Main Building, main floor (Room 106) at 9:45 AM | Hybrid**

A lead instructor teaches a five-week discussion using an HBBC resource.



## REFLECTIONS

This class is led by The Upper Room's Disciplines devotional guide. It is a seven-day-a-week spiritual journey through the areas that challenge, support, and articulate our faith. Reflections is a group of individuals from a varying range of backgrounds and ages that are lead by various class facilitators rather than teachers. Reflections offers opportunities to share, to listen, to learn, to fellowship, to pray, and to be involved with each other for the betterment of each individual and our collective faith community.

**Intergenerational, Married and Single | Chapel Wing, main floor (Room C-104) at 9:45 AM | Hybrid**

The facilitator instructs with discussion around Biblical text and application using Daily Disciplines.





## THE WELL

Are you thirsty; then come to the well. The Well is an intergenerational class made up of singles and couples, young and old. The class also gathers for times of fellowship and supports one another through prayer during the week.



### Intergenerational

**Main Building, second floor (Room 206)  
at 9:45 AM | Hybrid**

A team instructs with facilitated discussion using Lifeway Quarterly: Bible Studies for Life.



## YOUNG PROFESSIONALS

Graduate students, those who have recently finished college, or are just starting out in their career or adult life are encouraged to give this class a try. The class meets each Sunday from 9:45-10:30 AM which allows time for those that have responsibilities like choir and extended session to enjoy Sunday School and then head out.

**Young Adults/Career 25+ | Chapel Wing, second floor (Room C-206) at 9:45 AM**

A lead instructor teaches using a variety of resources.



## **PRESCHOOL AND GRADE SCHOOL CHILDREN**

Sunday School is provided for all ages on Sunday mornings. During Sunday School, children learn stories from the Bible and how they apply to our lives today.

### **Infants-Age 2 / Preschool I | Chapel Wing, ground floor at 9:45 AM**

A lead teacher and assistants use experiential center-based instruction.

### **Ages 3-Kindergarten / Preschool II | Family Life Center, main floor at 9:45 AM**

A lead teacher and assistants use experiential center-based and hands on learning.

### **Grades 1-5 / Children's Division | Main Building, second floor at 9:45 AM**

A lead teacher and assistants facilitate an active Bible study using Shine: Living in God's Light.

Following Sunday School, Extended Session is offered for infants through kindergartners during the 11:00 AM worship service. Extended Session is a time of play, crafts, and Bible stories provided by volunteers. Children of all ages are part of our worshiping congregation and are welcome in the Sanctuary on Sunday mornings. Worship bags are provided at each entrance to the Sanctuary on Sunday mornings.



In addition, Children's Church is held on the first, third, and fifth Sunday of every month during the school year.

Following the children's sermon, 1st-5th graders leave for a time of worship and fellowship that is child-oriented.

**Contact Sarah Mears ([smears@hbhc.org](mailto:smears@hbhc.org)) for more information about children's programs.**

## MIDDLE AND HIGH SCHOOL STUDENTS

Our youth meet on the second floor of the Family Life Center and enjoy conversational learning and Bible-based discussions utilizing various resources.

### **Grades 6-8 / Middle School | Family Life Center, second floor (FLC-200) at 9:45 AM**

Co-teachers use conversational learning and Bible-based discussions.

### **Grades 9-12 / High School | Family Life Center, second floor (FLC-205) at 9:45 AM**

Co-teachers use conversational learning and Bible-based discussions.

Our Sunday evening discipleship gathering includes supper, fellowship, recreation, and Bible study. Dinner starts at 6:00 PM followed by Youth Recreation and Large Group Time. Youth Small Groups (separated by grade and gender) start at 7:30 PM.

**Contact Kep Pate ([kpate@hbhc.org](mailto:kpate@hbhc.org)) for more information about youth programs.**

## SAFETY

In 2003, HBBC implemented a Child and Youth Protection Policy to ensure that we are doing everything in our power to protect both our children and our volunteers. The policy affirms our commitment to provide a safe place for our youth and children and provides specific guidelines for employees and volunteers. In November 2015, the deacons voted to approve changes to the Child and Youth Protection Policy, including a requirement that every volunteer working with children or youth complete an annual safety training and background check. We utilize a secure online resource called Protect My Ministry for our awareness training and background checks. In March 2020, the deacons voted to approve additional changes to the child protection policy, including provisions for overnight camps and retreats.



Class Name	Location	Member Profile
Preschool I	Chapel Wing Ground Floor	Infants-Age 2
Preschool II	Family Life Center Main Floor	Ages 3–Kindergarten
Children’s Division	Main Building Second Floor	Grades 1–5
Middle School	Family Life Center Second Floor, FLC-200	Grades 6–8
High School	Family Life Center Second Floor, FLC-205	Grades 9–12
Foundations	Chapel Wing Second Floor, Rm. C-205	Young Adults/Career 30+
Journey	Main Building Ground Floor, Rm. 29	Young Adults/Career 20+
Hailey	Main Building Second Floor, Rm. 204	Couples with Preschoolers, Children, and Youth & 35+
Genesis	Chapel Wing Second Floor, Rm. C-204	Co-ed 40+, Married & Single
The Well	Main Building Second Floor, Rm. 206	Intergenerational
Cashwell	Main Building Second Floor, Rm. 207	Co-ed, 60+, Parents of Young Adults
Koinonia	Main Building Second Floor, Rm. 200	Co-ed, 65+, Married and Single
Danielson	Main Building Ground Floor, Rm. 30	Co-ed, 70+, Married and Single
Fellowship	Main Building Main Floor, Rm. 111	Co-ed, 80+, Married and Single
Reflections	Chapel Wing Main Floor, Rm. C-104	Intergenerational, Married and Single
Young Professionals	Chapel Wing Second Floor, Rm. C-206	Young Adults/Career 25+
Membership Matters (Offered Quarterly)	Main Building Main Floor, Rm. 106	Newcomers



Teaching Style	Leadership	Resources
Experiential Center-Based Learning	Lead Teacher and Assistants	Various Resources
Center Based Learning	Lead Teacher and Assistants	Various Resources
Active Bible Study	Lead Teacher and Assistants	Shine: Living in God's Light
Conversational Learning and Bible-Based Discussions	Co Teachers	The Gospel Project
Conversational Learning and Bible-Based Discussions	Co Teachers	The Gospel Project
Facilitated Discussion	Co-Teachers	Various Resources
Discussion-Based	Co-Teachers	Various Resources
Facilitated Discussion	Teaching Team	Various Resources
Facilitated Discussion	Teaching Team	Lifeway Quarterly: Bible Studies for Life
Facilitated Discussion	Teaching Team	Lifeway Quarterly: Bible Studies for Life
Facilitated Discussion	Teaching Team	Smyth & Helwys Quarterly: Formations
Facilitated Discussion	Co-Teachers	Lifeway Quarterly: Bible Studies for Life
Facilitated Discussion	Teaching Team	Various Resources
Lecture and Discussion	Teaching Team	Smyth & Helwys Quarterly: Connections
Discussion around Biblical Text and Application	Facilitator	Lectionary; Daily Disciplines
Facilitated Discussion	Lead Teacher	Various Resources
5 Week Discussion at Various Times	Lead Teacher	HBBC Resource

Floor plan of the second floor. It shows three classrooms labeled C-206, C-205, and C-204 arranged vertically. Below C-204 are two offices, each containing a person icon. To the left of the offices is a set of stairs.

The floor plan of the second floor shows a series of rooms and corridors. At the top, rooms 220, 218, and 216 are adjacent to a room labeled CRC, which contains restrooms. To the right of CRC is E Archives, and further right is room 200. Below room 200 is room 206, which has a staircase. To the left of room 206 are rooms 213 and 207. Below room 207 is a large room labeled Baptistry. To the left of Baptistry is room 222. At the bottom left, there is a room labeled E. The plan also includes several corridors and smaller utility spaces.

The floor plan shows a rectangular building layout. At the bottom, an arrow points upwards to a doorway labeled "Chapel Entrance from White Oak and Memorial Garden". To the left of this entrance is a small room labeled "Prayer Room" containing a row of five pews. To the right of the entrance is a large open area labeled "Chapel C-101". At the top of the plan is a room labeled "C-104" with a door leading outside, indicated by a small figure of a person. A horizontal line separates the Chapel C-101 area from the C-104 room.

[illegible]

**Main Building Ground Floor**

The plan shows the following rooms and features:

- New Entrance:** Indicated by a downward arrow at the top left.
- Preschool Classrooms:** A large central area with two restrooms (indicated by male and female symbols).
- Machine Room:** Located below the preschool classrooms.
- Storage Room:** Two storage rooms are shown, one on the left and one to the right of the machine room.
- Office:** A small office is located to the right of the preschool classrooms.
- Handbell:** Located on the right side of the plan.
- Room Numbers:** Various numbers are placed throughout the plan, including 24, 25, 11, and 2.
- Work Room:** Located at the bottom right of the plan.

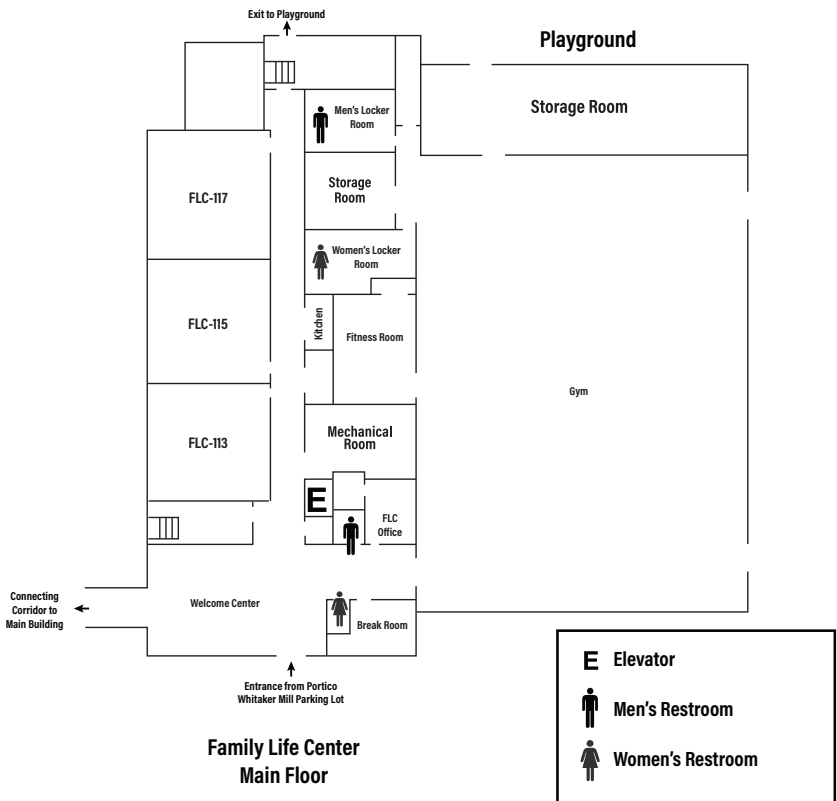
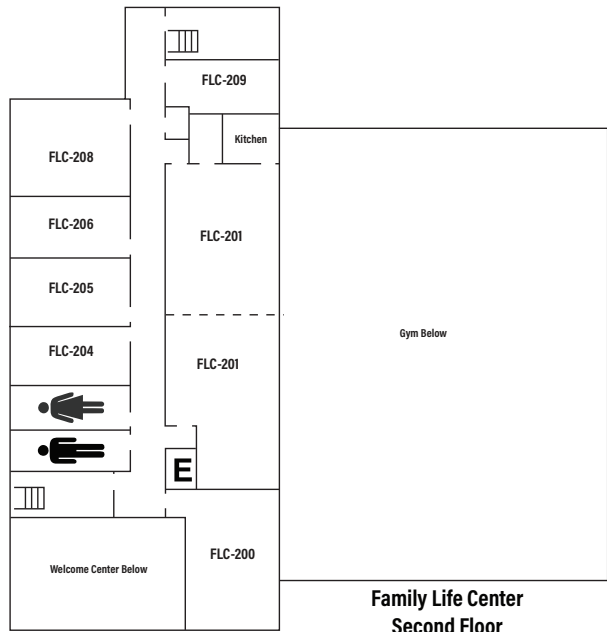

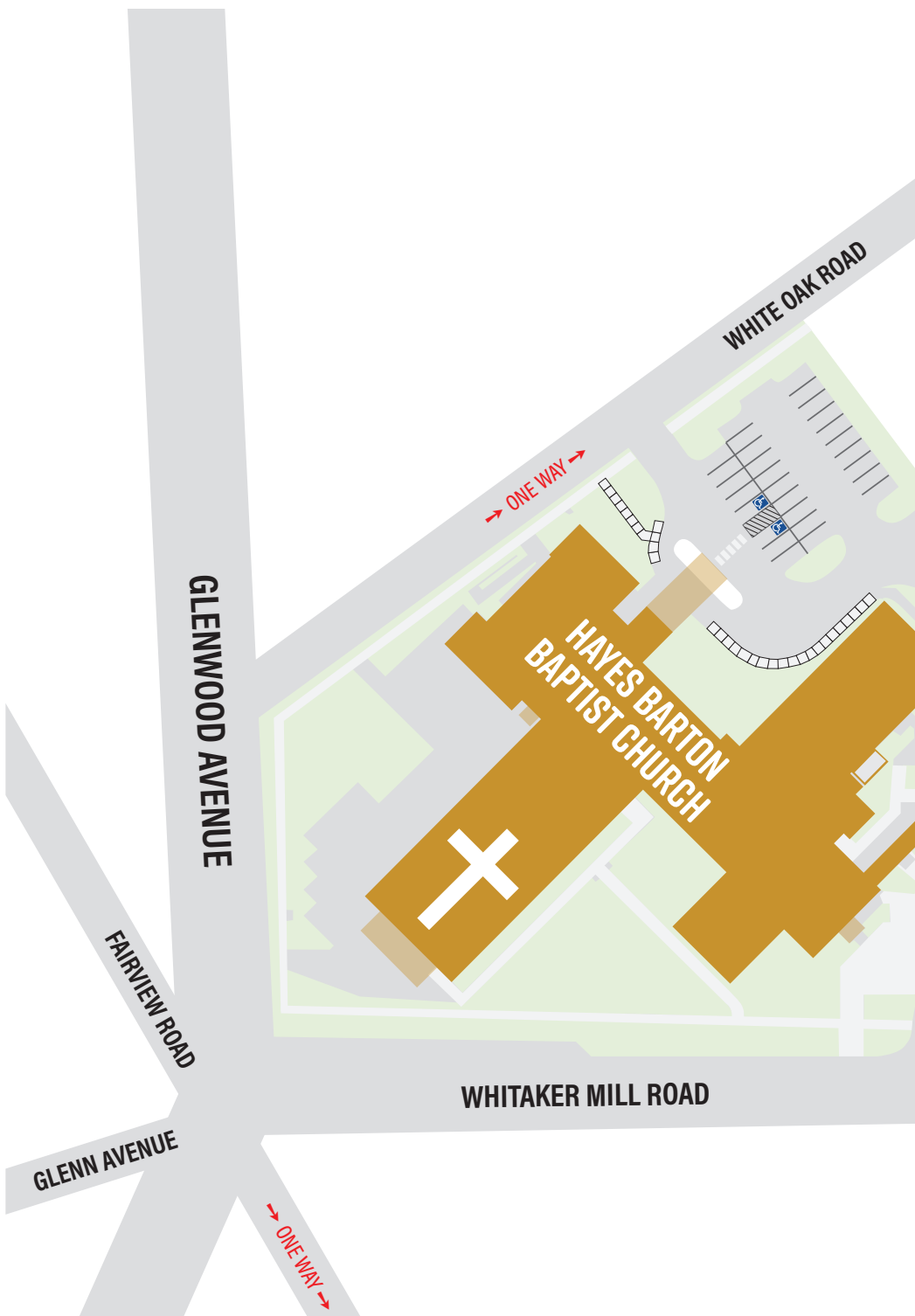



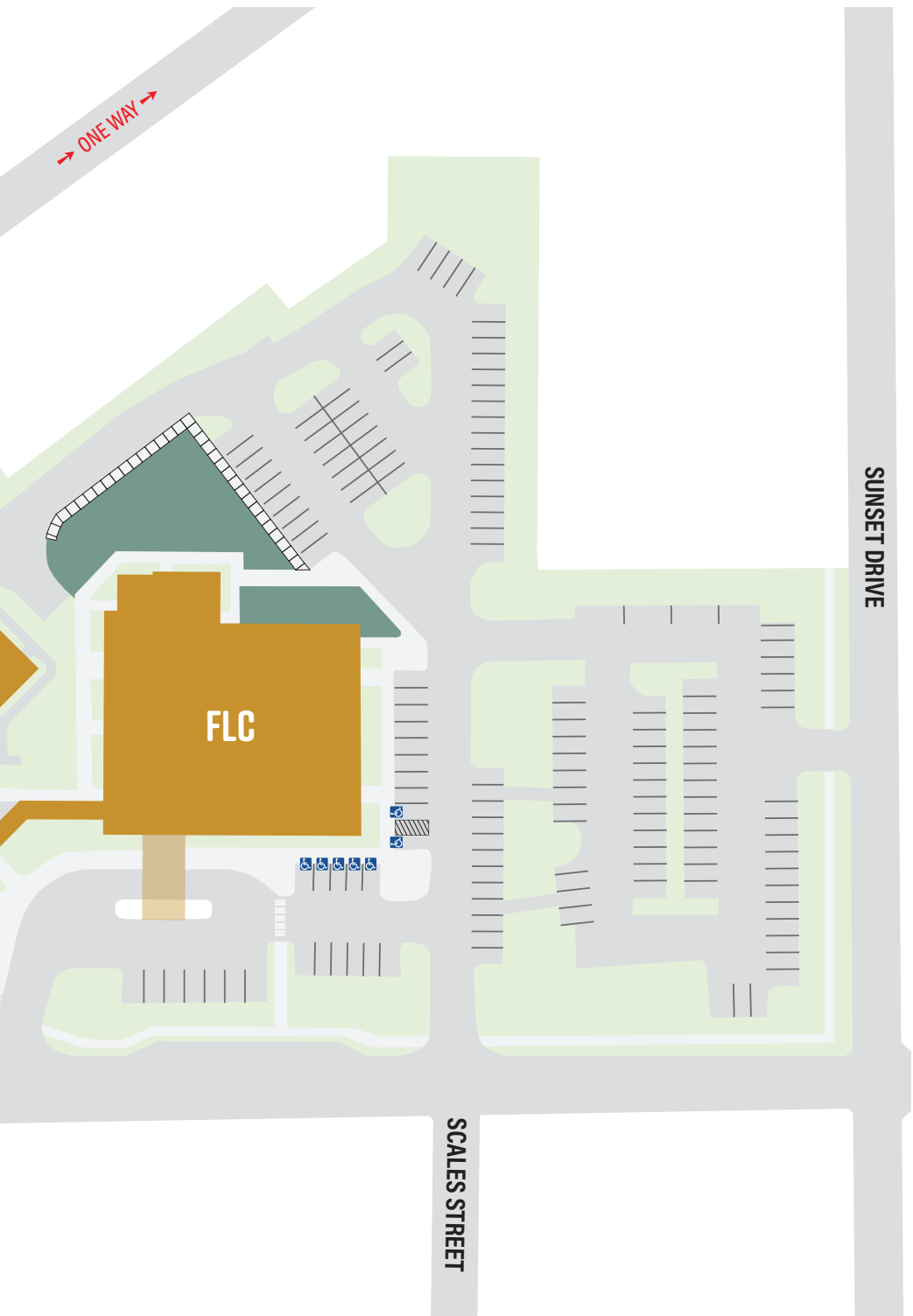

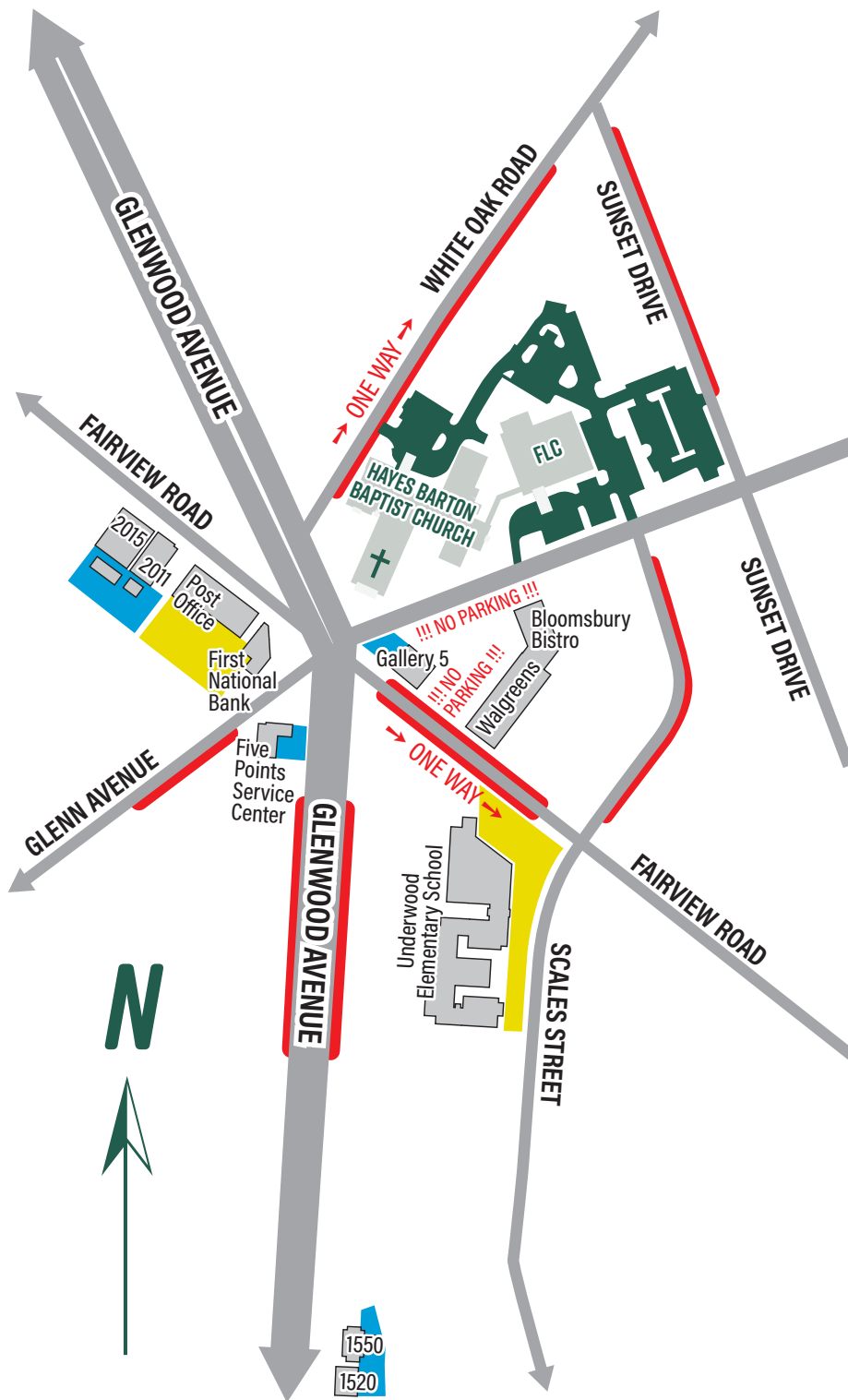



-  **Church Parking Lot**
-  **Community Partners Lots**  
(Available Sundays and Wednesday Nights)
-  **Business Parking Lots**  
(Available Sundays ONLY)
-  **Curb Parking**  
(Note Times on the Signs)

